

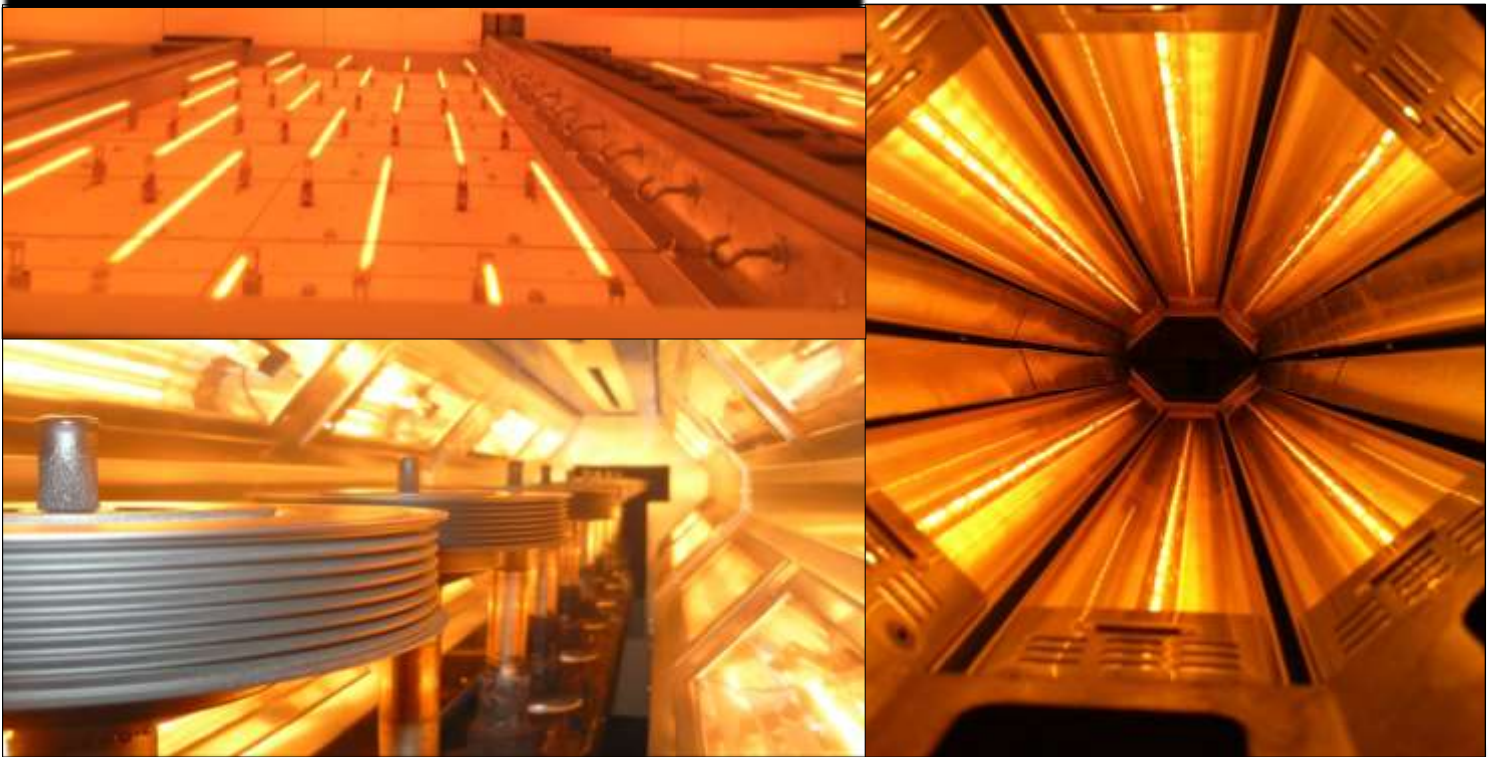

SHORT-WAVE INFRARED HEATERS



Our range of
standard products

I N F R A R O U G E

SHORT WAVE INFRARED HEATERS

The infrared radiation goes through the ambient air without heating it and is then transformed into heat when it meets an object. Non-standard solutions are available according to your specific needs: power, voltage, heating surface...

PAINT'IRC

Low power density: 5 to 30 kW/m². For uniform heating of fragile products, painted steel and plastic parts, for drying after coating, heating of thermoset materials...



IND'IRC

Medium power density: 30 to 100 kW/m². Heating of running products / profiles or localized heating



SM'IRC

High power density: 60 to 200 kW/m², for focused heating processes on small surfaces. Reactivation of glue, heating of running profiles...



IRC CERA

High power density: 30 to 500 kW/m², for surface ranges from several cm² to several m². Drying of paper, polymerization and drying of coatings, heating of thermoplastic composites...



SOP'ZONE

Heating indoors or outdoors, heating of stores, polymerization of thermoset resins

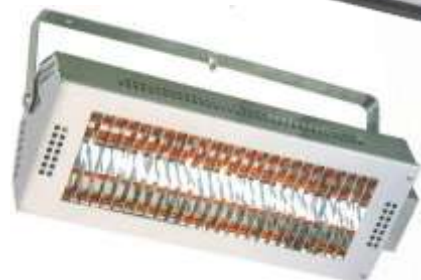

PAINT'IRC

Low power density: 5 to 30 KW/m². For uniform heating of fragile products, painted steel and plastic parts, for drying after coating, heating of thermoset materials

Description

- Multi-faceted reflector in treated aluminum
- Geometrical lay-out of PAINT'IRC : 150 x 425mm min.
- Frame made of aluminum profiles. H. 195mm
- 1 grid on the front side
- Power supply through pin plug
- Tube and reflector cooling through axial fans



Module PAINT'IRC – 1 tube

Lg x Lg x H mm	Power	Voltage	Reference
490x200x200	1000 W	230/240 V	SPC1.0PM049020D
490x200x200	1500 W	230/240 V	SPC1.5PM049020D
490x200x200	2000 W	230/240 V	SPC2.0PM049020D



Module PAINT'IRC – 2 tubes

Lg x Lg x H mm	Power	Voltage	Reference
490 x400x200	2X1000 W	230/240 V	SPC2.0PM049040D
490 x400x200	2X1500W	230/240 V	SPC3.0PM049040D
490 x400x200	2X2000W	230/240 V	SPC4.0PM049040D
930 x200x200	2X1000 W	230/240 V	SPC2.0PM093040D
930 x200x200	2X1500W	230/240 V	SPC3.0PM093040D
930 x200x200	2X2000W	230/240 V	SPC4.0PM093040D

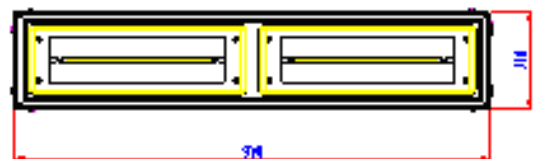

Module PAINT'IRC – 3 tubes

Lg x Lg x H mm	Power	Voltage	Reference
530x490x200	3X1000 W TRI+N	230/240 V	SPC3.0PM049053D
530x490x200	3X1500W TRI+N	230/240 V	SPC4.5PM049053D
530x490x200	3X2000W TRI+N	230/240 V	SPC6.0PM049053D



*Bright or anti-glare tube

OPTIONS:

- 1 protection glass on the front side, protecting the reflector from pollution
- Cable gland and cable 1,5 m

IND'IRC

Medium power density 30 to 100 kW/m². For heating of running products / profiles or for localized heating

Description

- Short-wave infrared heater with reflector of aluminum
- Width of the reflector: 55 mm
- Aluminum frame with mounting brackets
- Power supply through min plug or cable
- Tube and reflector cooling through axial fan
- 1 protection glass as option

AVANTAGES

- Instant and directional heat
- High power
- Very short treatment time
- Perfectly homogeneous heating
- Very precise regulation
- High efficiency
- Significant energy savings

Parabolic module – 1 tube

Lg x Lg x H mm	Power	Voltage	Reference
370 x 85 x 150	1000 W	230/240V	EC1.0UM360L
370 x 85 x 150	2000 W	230/240 V	EC2.0UM360L
370 x 85 x 150	2000 W	400 V	EC2.0VM360L
510 x 85 x 150	2000 W	400V	EC2.0VM500L
800 x 85 x 150	3000 W	400 V	EC3.0VM800L

EC1.0UM360L



Parabolic module – 2 tubes

Lg x lg x H mm	Power	Voltage	Reference
240x165x150	2X500 W	240 V	SPC1.0UM0240016A
370x165x150	2X1000 W	240 V	SPC2.0UM037016A
370x165x150	2X2000 W	240 V	SPC4.0UM037016A
370x165x150	2x2000 W	400 V	SPC4.0VM037016A
510x165x150	2x2000 W	400 V	SPC4.0VM051016A
800x165x150	2x3000 W	400 V	SPC6.0VM080016A

SPC1.0UM0240016A



Parabolic module – 3 tubes

Lg x Lg x H mm	Power	Voltage	Reference
370 x 250 x 150	3X1000 W	230/240V	SPC3.0UM037025A
370 x 250 x 150	3x2000 W	230/240 V	SPC6.0UM037025A
370 x 250 x 150	3x2000 W	400V	SPC6.0VM037025A
510 x 250 x 150	3x2000 W	400V	SPC6.0VM051025A
800 x 250 x 150	3x3000 W	400 V	SPC9.0VM080025A

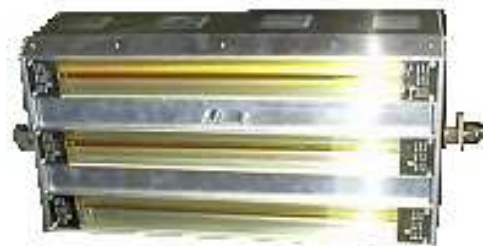

* Temperature measurement by the means of a PYROMETER with double laser targeting system - option on all models.

SM'IRC

High power density: 60 to 200 k/m², for focused heating processes on small surfaces.
Reactivation of glue, heating of running profiles...

Description

Short-wave infrared heater composed of :

- 1 aluminum reflector: width 22 mm
- 1 stainless steel frame with openings for cooling
- High temperature sheaths for electrical wiring
- 1 short-wave infrared tube, assembly from the front side

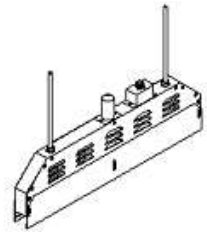

Cooling system

Unit for 3 to 6 SM'IRC:

- 1 centrifugal fan
- 1 filter mounted on the suction inlet
- 1 blowing chamber 350x250x200 equipped with 3 to 6 outlets - Ø25 ext.
- 3 ml coiled cable for each outlet (the cable may be cut, if necessary)
- 2 clamping rings for each flexible cable
- Left-side version: fan on the left side (see adjacent figure)
- Right-side version: fan on the right side

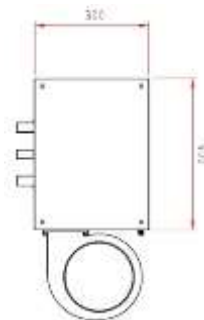
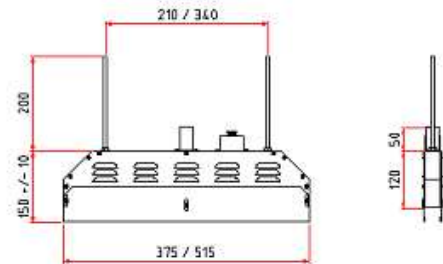

Dim. Reflector	Power	Voltage	Reference
360 x 22 mm	2000 W	230 V	SPC2.0UM360I
500 x 22 mm	2000 W	400 V	SPC2.0VM500I

HIGH POWER DENSITY HEATER IRC Céra

High power density: 30 to 500 kW/m², for surface ranges from several cm² to several m².
Drying of paper, polymerization and drying of coatings, heating of thermoplastic composites...

Standard heater IRC Flash

Short-wave infrared heater 153 x 240 mm, for drying of ink after tampo-printing
(see table below)

This module includes 2 to 4 lamps with total power from 600 W to 2400 W. The module requires a power supply of 230 V – (pluggable connector).

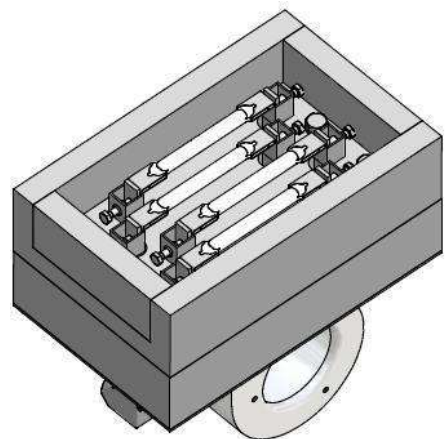

Power	Voltage	Description	Reference
600W	230V	2 lamps x 300 W	EC600PM240
1200W	230V	4 lamps x 300 W	EC1.2PM240
2400W	230V	4 lamps x 600 W	EC2.4PM240

Type of application :

Module for drying of ink, tampo-printing, polymerization of resins...

Option :

Control box with safety devices and control systems, cable and pluggable connector on the side of the short wave IR heater

HEATING OF INDUSTRIAL PREMISES

These short-wave IR heaters ensure a high efficiency and a good heating homogeneity

Heating indoors or outdoors, heating of stores, polymerization of thermoset resins

Description

- Multi-faceted reflector in treated aluminum + aluminum frame
- Stainless steel version for the agri-food industry and for animal farming
- 1 protection grid on the front side
- Power cable 1.5 ml + plug 230 V (OPTION)
- Infrared tubes for any position – Power 1000 W, 1500 W or 2000 W
- Bright tube (white light) or anti-glare tube (red light)

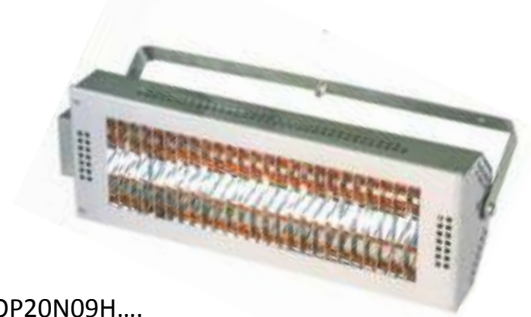

SOP20N09H....



Advantages

- Instant heating effect to occupant level
- Very high thermal efficiency
- Possibility of zoned heating and presence-controlled intermittent heating
- Precise and flexible regulation
- Very good heat distribution
- Very fast temperature rise
- Significant energy savings
- No additional floor space is required, easy installation and maintenance (space saving and lightweight heater)
- Silent heating (no air movement)
- Simple power supply



SOP20N42

**QUICK RESPONSE, ECONOMY,
QUALITY, SAFETY**



SOPARA

27 rue des Bruyères
ZI du Mariage
69330 Pusignan – France



+33 (0) 472 812 300



+33 (0) 472 812 309



contact@sopara.com



www.sopara.com

